

MA Series Stainless Steel Mini Cylinder



MA 25 x 50



MAJ 25 x 50-25

Ordering Code

MA

Type

MA: Double Action Type
 MSA: Single Extrusion Type
 MTA: Single Drawing-in Type
 MAD: Double-shaft Double Action Type
 MACD: Double-shaft Double Action Damping Type
 MAJ: Double-shaft and Adjustable Stroke Type
 MAC: With Cushion Type



Back Cover Type

Blank: Fishtail type
 CM: Rounded type
 U: Horizontal type

20 × 50

Cylinder Bore

16mm~40mm

Stroke

25

Adjustable Stroke Type

0~100mm

S

Magnet Code

Blank: Without Magnet
 S: With Magnet



Fixed Type

Blank: Normal type
 LB: Front and back fixed type
 FA: Front cover fixed type
 SDB: Back cover swinging type
 U: Back cover fixed type

Internal structure

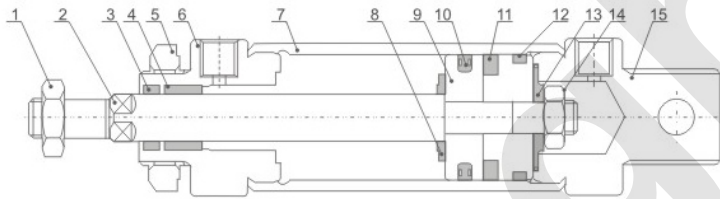

NO	Designation	NO	Designation
1	Piston Rod Nut	2	Piston Rod
3	Front Cover Seal Ring	4	Oiled Bearing
5	Front Cover Nut	6	Front Cover
7	Stainless steel tube	8	Anti-crash cushion
9	Piston	10	Piston O-Ring
11	Magnet(Optional)	12	Wear ring
13	Back cushion	14	Hex socket screw
15	Back Cover		

Specification

Bore(mm)	16	20	25	32	40
Motion pattern	Double Action or Single Action				
Working Medium	Air				
Fixed Type	Normal Type	LB Type	FA Type	SDB Type	U Type
Operating Pressure Range	0.1~0.9MPa				
Ensured Pressure Resistance	1.35MPa				
Operating Temperature Range	-5~70°C				
Operating Speed Range	50~800mm/s				
Buffer Type	Standard Type	Anti-crash cushion			
	Damping Type	Adjustable cushion			
Port Size	M5×0.8	G1/8"	G1/8"	G1/8"	G1/8"

■ Our Company can also make flat for cylinder covers inlet and outlet position. If you require this, it should be specified.

Stroke

Bore(mm)	Standard Stroke										Max.Stroke	Permissible Stroke					
16	25	50	75	80	100	125	160	175	200		300	500					
20	25	50	75	80	100	125	160	175	200	250	300	500	650				
25	25	50	75	80	100	125	160	175	200	250	300	350	400	450	500	500	650
32	25	50	75	80	100	125	160	175	200	250	300	350	400	450	500	500	650
40	25	50	75	80	100	125	160	175	200	250	300	350	400	450	500	500	650

MA Series Stainless Steel Mini Cylinder

Overall Dimensions

MA

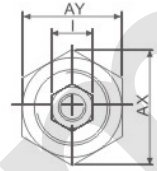
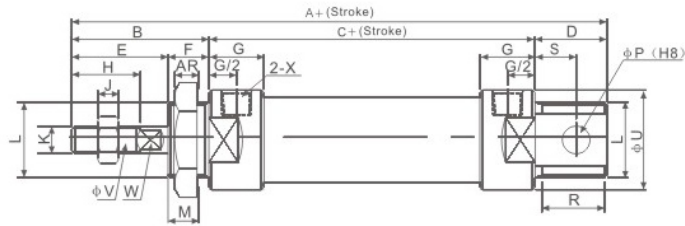

MA-CM

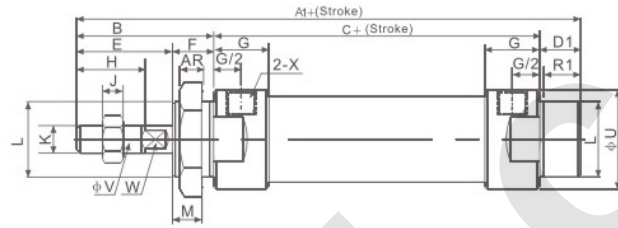

MA-U

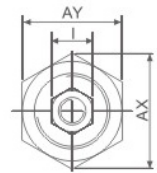
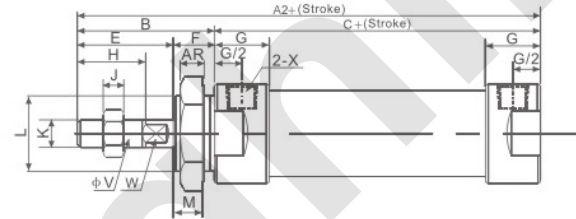

Dimension Sheet

Bore/Symbol	A	A1	A2	B	C	D	D1	E	F	G	H	I	J	K
16	114	114	98	38	60	16	16	22	16	10	16	10	5	M6×1
20	137	128	116	40	76	21	12	28	12	16	20	12	6	M8×1.25
25	141	134	120	44	76	21	14	30	14	16	22	17	6	M10×1.25
32	147	134	120	44	76	27	14	30	14	16	22	17	6	M10×1.25
40	149	136	122	46	76	27	14	32	14	16.7	24	17	7	M12×1.25

Bore/Symbol	L	M	P	Q	R	R1	S	U	V	W	X	AR	AX	AY
16	M16×1.5	14	6	12	14	14	9	21	6	5	M5	6	24	27.5
20	M22×1.5	10	8	16	19	10	12	27	8	6	G1/8"	7	33	29
25	M22×1.5	12	8	16	19	12	12	30	10	8	G1/8"	7	33	29
32	M24×2.0	12	10	16	25	12	15	35	12	10	G1/8"	8	37	32
40	M30×2.0	12	12	20	25	12	15	41.6	16	14	G1/8"	9	47	41

MAL6432 Series Aluminum alloy mini cylinder(ISO 6432)



MAL6432 20 x 75

Specification

Motion Pattern	Double Action or Single Action
Operating Pressure Range	0.1~0.9MPa
Ensured Pressure Resistance	1.35MPa
Operating Temperature Range	-5~70℃
Operating Speed Range	30~800mm/s

Product instruction

Our company can also provide MAL series ISO6432 standard aluminum alloy mini cylinder, if you need this, pls change ordering code MAL into MAL6432.

MA Series Stainless Steel Mini Cylinder

Overall Dimensions

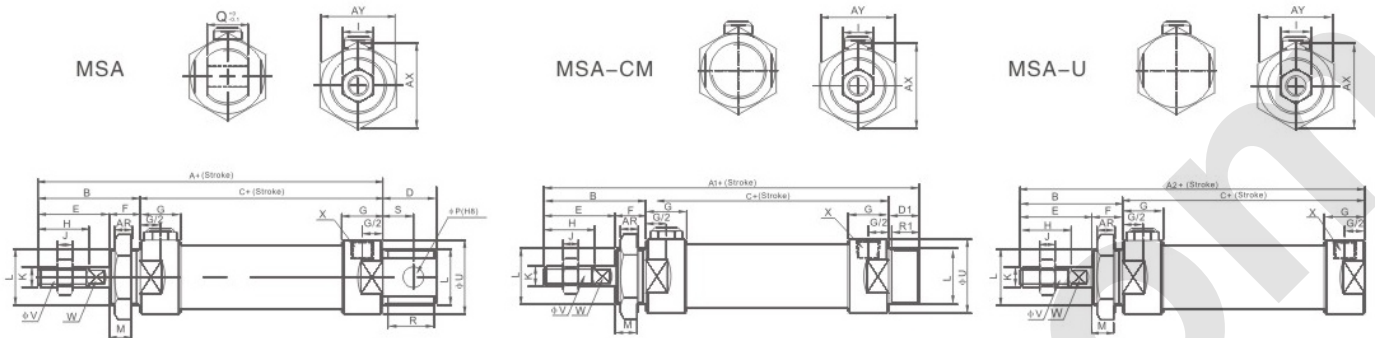

Dimension Sheet

Symbol Bore/Stroke	A		A1		A2		B	C		D	D1	E	F	G	H	I	J
	0-50	51-100	0-50	51-100	0-50	51-100		0-50	51-100								
16	114	139	128	153	98	123	38	60	85	16	16	22	16	10	16	10	5
20	137	162	134	159	116	141	40	76	101	21	12	28	12	16	20	12	6
25	141	166	134	159	120	145	44	76	101	21	14	30	14	16	22	17	6
32	147	172	136	161	120	145	44	76	101	27	14	30	14	16	22	17	6
40	149	174	122	144	122	147	46	76	101	27	14	32	14	16.7	24	17	7
Inside Diameter/Symbol	K		L		M	P	Q	R	R1	S	U	V	W	X	AR	AX	AY
16	M6×1		M16×1.5		14	6	12	14	14	9	21	6	5	M5	6	25	22
20	M8×1.25		M22×1.5		10	8	16	19	10	12	27	8	6	G1/8"	7	33	29
25	M10×1.25		M22×1.5		12	8	16	19	12	12	30	10	8	G1/8"	7	33	29
32	M10×1.25		M24×2.0		12	10	16	25	12	15	35	12	10	G1/8"	8	37	32
40	M12×1.25		M30×2.0		12	12	20	25	12	15	41.6	16	14	G1/8"	9	47	41

Overall Dimensions

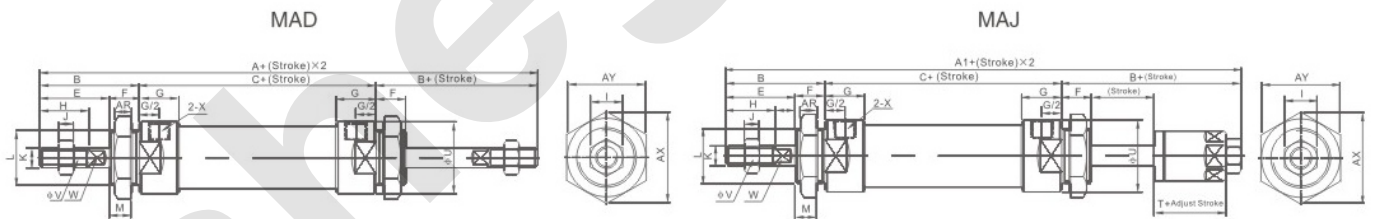

Dimension Sheet

Inside Diameter/Symbol	A	A1	B	C	E	F	G	H	I	J	K
16	136	135	38	60	22	16	10	16	10	5	M6×1
20	156	153	40	76	28	12	16	20	12	6	M8×1.25
25	164	161	44	76	30	14	16	22	17	6	M10×1.25
32	164	161	44	76	30	14	16	22	17	6	M10×1.25
40	168	164	46	76	32	14	16.7	24	17	7	M12×1.25
Inside Diameter/Symbol	L	M	U	V	W	X	AR	AX	AY	T	
16	M16×1.5	14	21	6	5	M5	6	25	22	16	
20	M22×1.5	10	29	9	6	G1/8"	7	33	29	19	
25	M22×1.5	12	34	10	8	G1/8"	7	33	29	21	
32	M24×1.5	12	39.5	12	10	G1/8"	8	37	32	21	
40	M30×2.0	12	41.6	16	12	G1/8"	9	47	41	21	